



## Technical Datasheet

### Connolly DuraJoint® EXJ

The Connolly DuraJoint® EXJ is a continuous pour solution for concrete footpaths, cycleways, driveways, and various urban concrete pavements. DuraJoint® EXJ is a versatile and robust corrosion-resistance leave in place formwork which allows for 10mm expansion while transferring the load across the joint utilising Glass Fibre Reinforced Polymer dowel bars. The DuraJoint® EXJ profile has pre-formed holes which allow it to be used in conjunction with Connolly Universal Dowel Sleeves (UDS). A wide range of permanent capping and rebate moulds are available to be used with DuraJoint® EXJ.

**Features:**

- Enables continuous pours
- Allows up to 10mm expansion
- Corrosion-resistance, suitable for any applications exposed to salt-water
- Surpasses the requirements of AS 3727.1:2016 Residential Pavements
- Non-metallic accessories
- Bottom overhang of expansion foam to accommodate any unevenness of base layer
- Twist-fix feature provides alignment of dowels for unhindered slab movement
- Patented wedge fixing mechanism allows fast and accurate height adjustment
- Easy installation using provided accessories
- Straight profile allows to be used as a screeding rail
- Permanent capping and rebate mould available

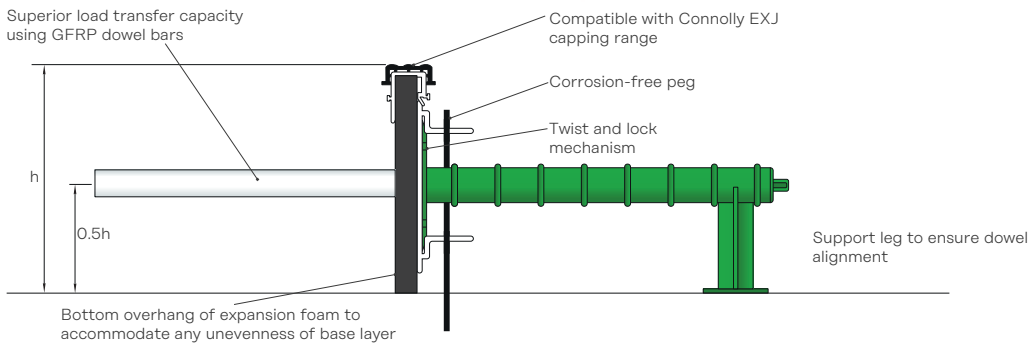
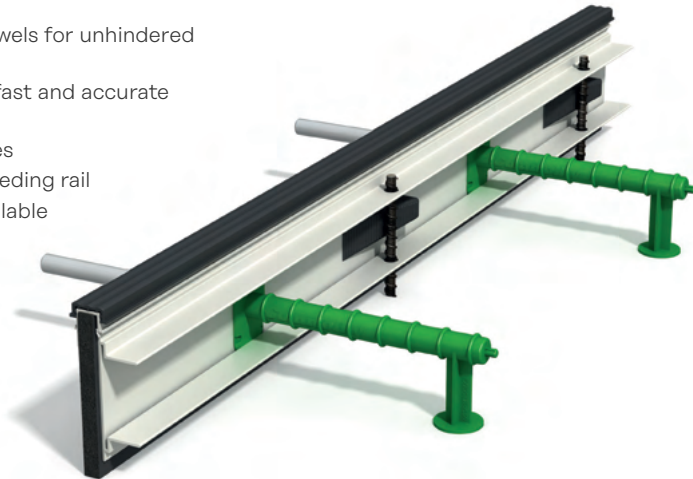
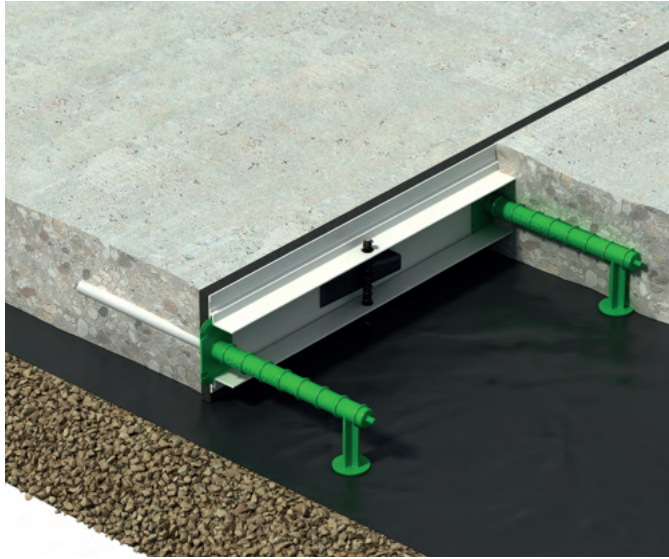

# Technical Datasheet

## Connolly DuraJoint® EXJ

### Load transfer capacities

Connolly DuraJoint® EXJ complies with the requirements of AS 3727.1:2016 Residential Pavements. A test series conducted by a third party confirms Connolly DuraJoint® EXJ 100 surpasses AS 3727.1:2016 requirements.

### Connolly DuraJoint® EXJ technical and GFRP dowel strength data in compliance with requirements of AS 3727.1:2016

DuraJoint® Dowel details	Slab Thickness (mm)	Min. Concrete Strength (MPa) AS 3727.1:2016	Vehicle Type AS 3727.1:2016	Axle Load (kN)	Load on single Dowel (kN)	DuraJoint® Design Capacity per Dowel (kN)	Capacity Safety Factor
GFRP 12.7mm @ 335mm c/c	100	25	3 tonne light vehicle (LV)	20	4	9.5	1.9

**Note:** For more information, please contact the Leviat technical team on 1300 304 320 or email [technical.au@leviat.com](mailto:technical.au@leviat.com)

### Packing details

DuraJoint® Expansion Joint 100mm x 3.0m. Box of 10 Kit box containing 10 x Pegs and Wedges (4-pack), 9 x Sleeves



### Connolly DuraJoint® Family

Connolly DuraJoint® EXJ and DuraJoint® KJ form a product family that is developed to fulfil the councils and contractors needs in accordance with AS 3727.1:2016 Residential Pavements.



# Technical Datasheet

## Connolly DuraJoint® EXJ

### Installation Instructions

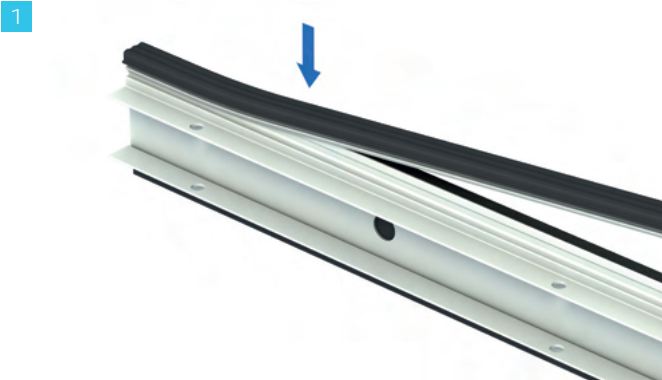

In the case where permanent capping or a rebate mould is used, ensure it is pushed firmly onto the top of the system prior to placement.

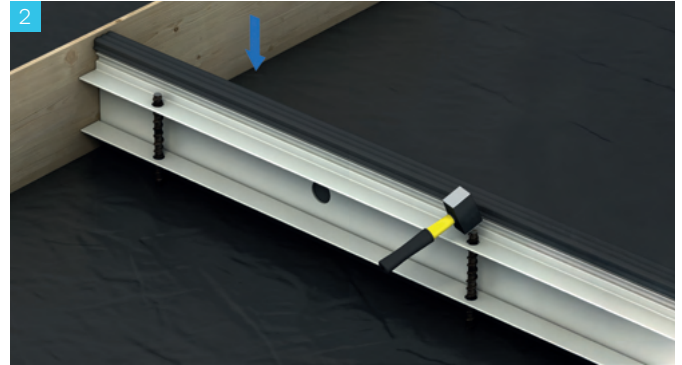

Position the expansion joint profile in the desired location and drive in the supplied pegs. Ensure the top of the peg is at least 20mm below the intended level of the finished concrete.

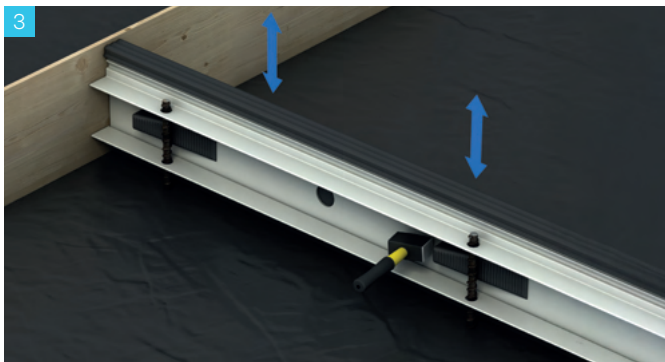

Adjust the profile to the correct height and secure by tapping in the supplied wedges.

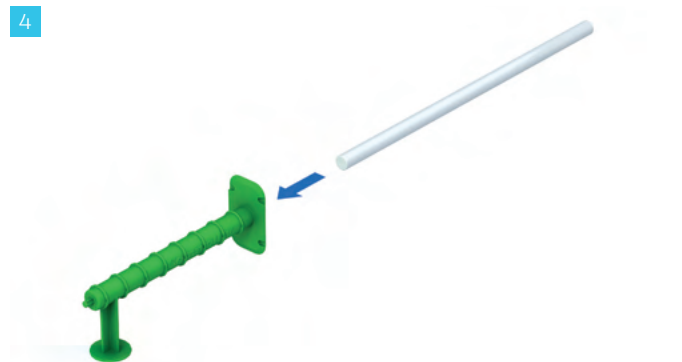

Insert dowels into the Universal Dowel Sleeves by pressing all the way to the end of the sleeve.

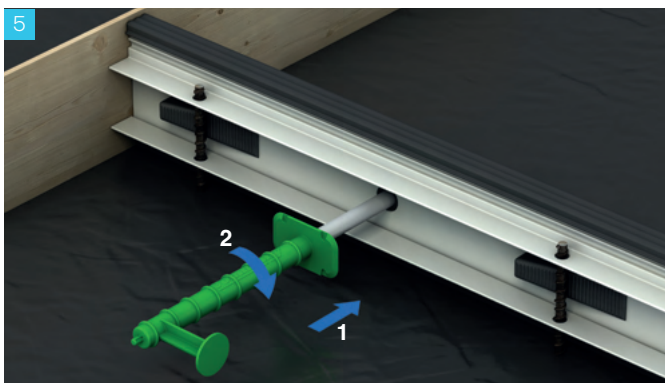

Install the Universal Dowel Sleeve in the profile by pushing the dowel through the foam at the centre of the pre-punched holes and twist the sleeve 90 degrees to fix in place.

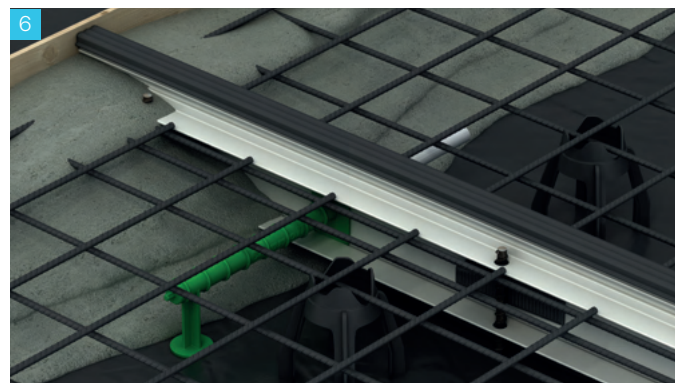

Place reinforcement and pour concrete evenly to both sides of the expansion joint at the same time. Finish surface and ensure top of joint is clear of any concrete.